



Past and Present

Issue 7: Fall 2008

Probate Cases Index Online

The index to the Archives' collection of probate cases is now available online at the Archives' website. The index is another step in the Archives' goal of providing online access to as many guides to its records as possible. The index may be searched by name or date or other keywords.

(Continued on page 2)

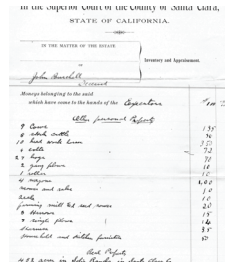

Inventory of a Gilroy farm from a probate case.

Historic Maps Discovered

The Archives has identified a number of historic maps during its inventory of large rolled maps transferred by County Surveyor Gwen Gee. Conducted by Assistant Archivist Trista Raezer, the survey will furnish basic information about the maps and provide a basis on which storage and preservation decisions can be made.

Among the maps found so far, several document Santa Clara County in the first decades of its existence. These include an 1866 map of the town of Santa Clara, which shows the names of property owners. Also located is an 1874 Official Map of the County of Santa Clara, apparently the only copy in the state.

(Continued on page 2)

Mission

The mission of the Santa Clara County Archives is to collect, preserve, and make available the historical records of Santa Clara County government. The Archives' goals are to be a center for research and information about Santa Clara County and to foster an appreciation and understanding of the county's history and development.

Archives Home for New Almaden Records during Reconstruction



The Casa Grande at New Almaden when it was operated as a hotel. The mine superintendent's residence will be restored to its original exterior and interior.

During the next year and a half, the Archives will be the temporary home of the historic collections of New Almaden County Park. During that period, the Casa Grande, the original home of the mine superintendent, will be restored to its original splendor by the County Department of Parks and Recreation.

The historic collections consist of a rich variety of photographs, printed material, and ephemera documented the over-century-long history of the mine. Volunteers have been carefully cataloging and organizing the materials for several years, and those efforts will continued while the collections are at the Archives.

“The Archives is happy to provide a temporary

(Continued on page 2)

Past and Present

Probate Index (continued)

The collection includes about 2,100 cases filed from 1897 to 1908. The cases, which are available in the Archives, are a rich source of information about individuals and daily life. They include wills and detailed lists of property and provide insight into the operation of farms, businesses, and professions. They will be of value to genealogists and to those researching social and economic conditions in the early 1900s.

The index was created by dedicated volunteers who, over a period of many months, examined each case file. Many of these volunteers previously created the index to the Archives' wills collection. According to the County Archivist, "Without the extraordinary efforts of our volunteers, we never would have been able to provide the access the public now enjoys. My hat is off to them!"

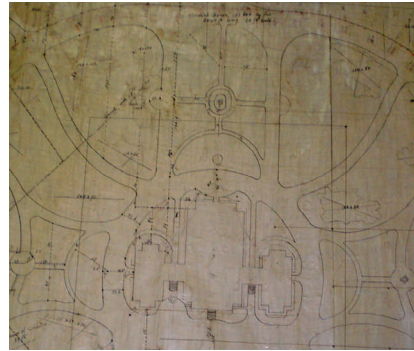

Part of the plan for the San Jose Normal School grounds, showing the larger school building constructed in 1880.

Historic Maps (continued)

A third unusual find is a plan for the grounds of San Jose Normal School, the predecessor of San Jose State. Evidence from the drawing indicates the plan was made between 1880 and 1890.

After the inventory, some maps will require conservation before they can be safely handled. In addition, a special storage system will need to be created for the largest, which will not fit inside map cases. The project's result will be improved access to historic maps of the county.

New Almaden (continued)

home for these important records," the County Archivist stated. "We are looking forward to providing space so that New Almaden volunteers may continue their valuable work."

After the reconstruction, the collections will return to the Casa Grande. The reconstructed building will include a secure vault area for the records, which will be available to the public on site.

Contacting the Archives

Our address: 1875 Senter Road, San Jose 95112

Directions: Please see our website at <http://archives.sccgov.org>.

Our phone: 408-792-1895

E-mail: Archives@rec.sccgov.org

Hours: We are open Monday, 10-4 and Wednesday, 9-1. Appointments are normally available the remainder of the week, Monday through Friday.

Subscribing

To subscribe (or unsubscribe) to this Newsletter, please send an e-mail to: Michael.Griffith@rec.sccgov.org.

COUNTY HIGHLIGHT

Registrar of Voters

The images below illustrate the variety of records at the Archives documenting the history of the Registrar of Voters. The Archives' holdings include both ballots and other election materials and records illustrating the conduct of elections.



The three photos on this page are part of a series taken in 1966 to document the use of computerized vote counting equipment. This picture shows ballots being fed into the Votronic counter.

In this picture, precinct summary cards are fed into the IBM 1401 system.



Equipment used to produce print-outs of election results by precinct with periodic summaries by candidates and measures.

